

08 Nov 2019 14:52

© 2019. The copyright of this document is the property of Glass Vice Limited and shall not be reproduced, copied, loaned or disposed of directly, or indirectly, nor used for any purpose other than that for which it is specifically furnished without prior consent.

gv_vertbatt_Corey.rvt
 All dimensions in millimetres



Vertical Battens

1200mm High Face Fixed into Timber

Section - Face Fix Triple Joist Door 1.2M Residential Barrier - 200 Top Rail

Date: October 2019

Scale: 1 : 10

Issue 01

www.glassvice.com

Phone +64 9 414 6565

info@glassvice.com

_VB1212_160

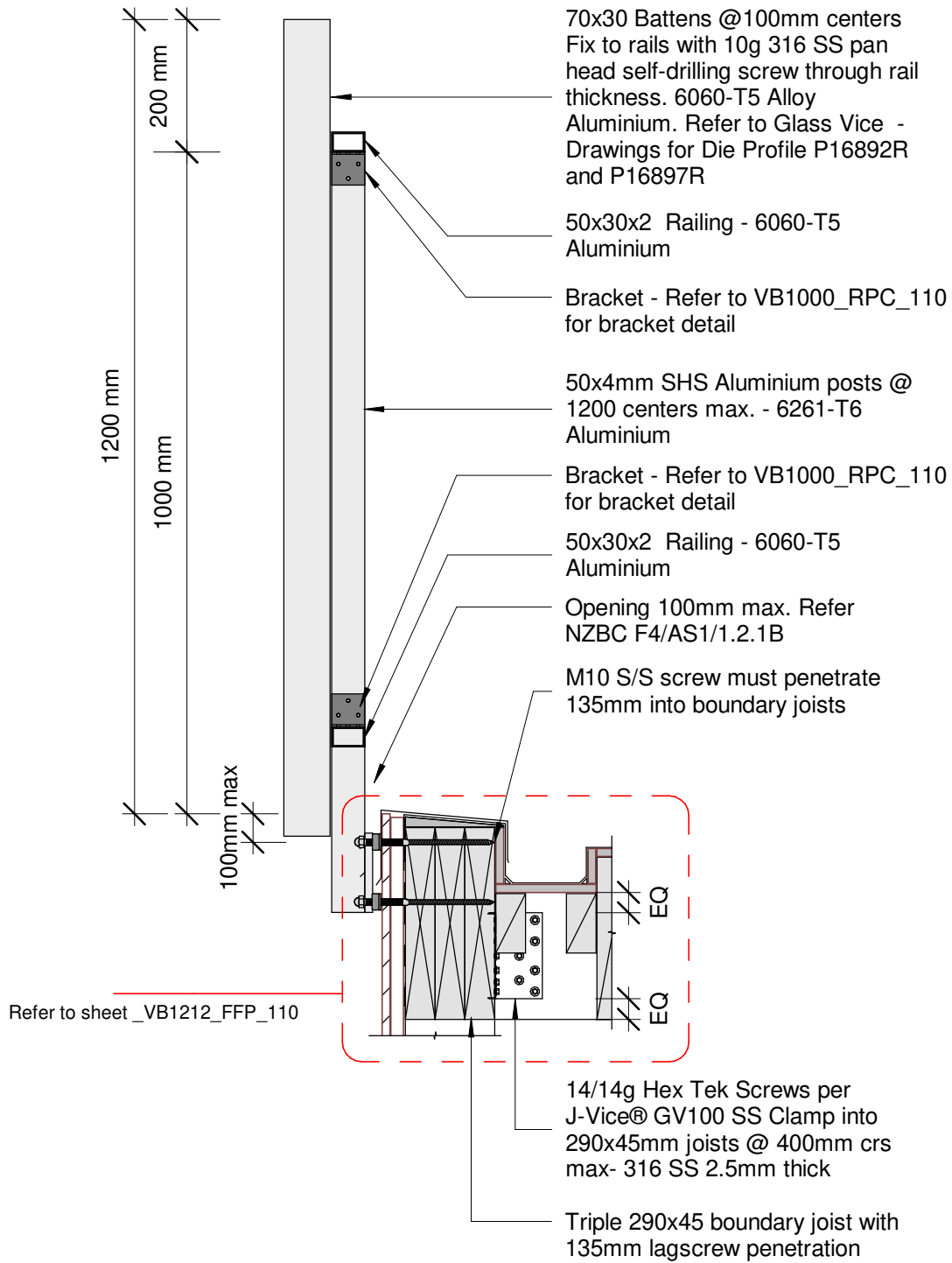

08 Nov 2019 14:52

© 2019. The copyright of this document is the property of Glass Vice Limited and shall not be reproduced, copied, loaned or disposed of directly, or indirectly, nor used for any purpose other than that for which it is specifically furnished without prior consent.

gv_vertbatt_Corey.rvt
 All dimensions in millimetres



Vertical Battens

1200mm High Face Fixed into Timber

Date: October 2019

Scale: 1 : 10

Issue 01

www.glassvice.com
 Phone +64 9 414 6565
 info@glassvice.com

Section - Face Fix 190 Standoff Vertical Batten 1.2M Residential Barrier - 200 Top Rail_VB1212_170

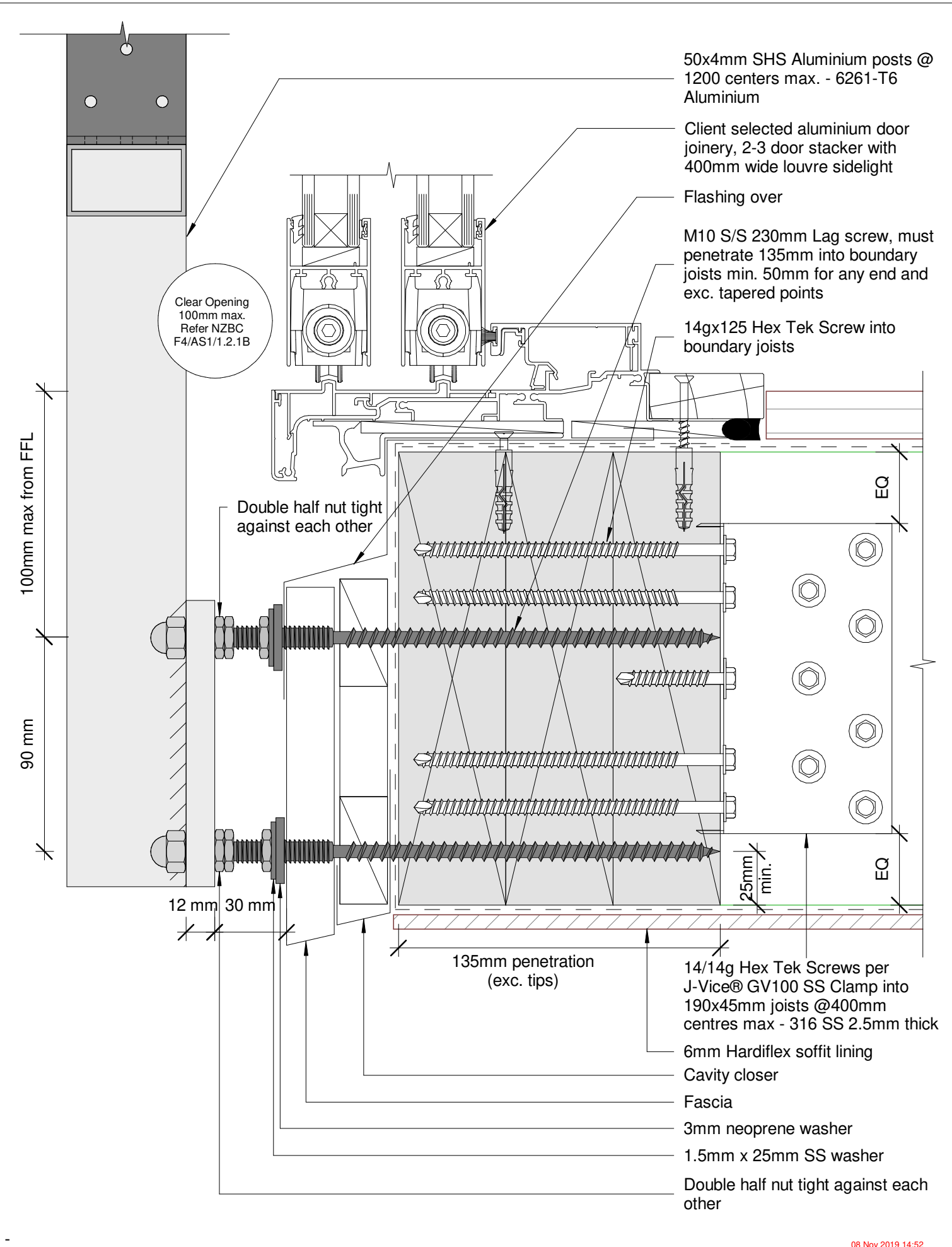

- 50x4mm SHS Aluminium posts @ 1200 centers max. - 6261-T6 Aluminium
- Client selected aluminium door joinery, 2-3 door stacker with 400mm wide louvre sidelight
- Flashing over
- M10 S/S 230mm Lag screw, must penetrate 135mm into boundary joists min. 50mm for any end and exc. tapered points
- 14x125 Hex Tek Screw into boundary joists
- 14/14g Hex Tek Screws per J-Vice® GV100 SS Clamp into 190x45mm joists @400mm centres max - 316 SS 2.5mm thick
- 6mm Hardiflex soffit lining
- Cavity closer
- Fascia
- 3mm neoprene washer
- 1.5mm x 25mm SS washer
- Double half nut tight against each other

Clear Opening
100mm max.
Refer NZBC
F4/AS1/1.2.1B

100mm max from FFL

90 mm

12 mm 30 mm

135mm penetration
(exc. tips)

25mm
min.

EQ

EQ

08 Nov 2019 14:52

© 2019. The copyright of this document is the property of Glass Vice Limited and shall not be reproduced, copied, loaned or disposed of directly, or indirectly, nor used for any purpose other than that for which it is specifically furnished without prior consent.

gv_vertbatt_Corey.rvt
All dimensions in millimetres



Vertical Battens

1200mm High Face Fixed into Timber

Date: October 2019
Scale: 1 : 2
Issue 01

www.glassvice.com
Phone +64 9 414 6565
info@glassvice.com

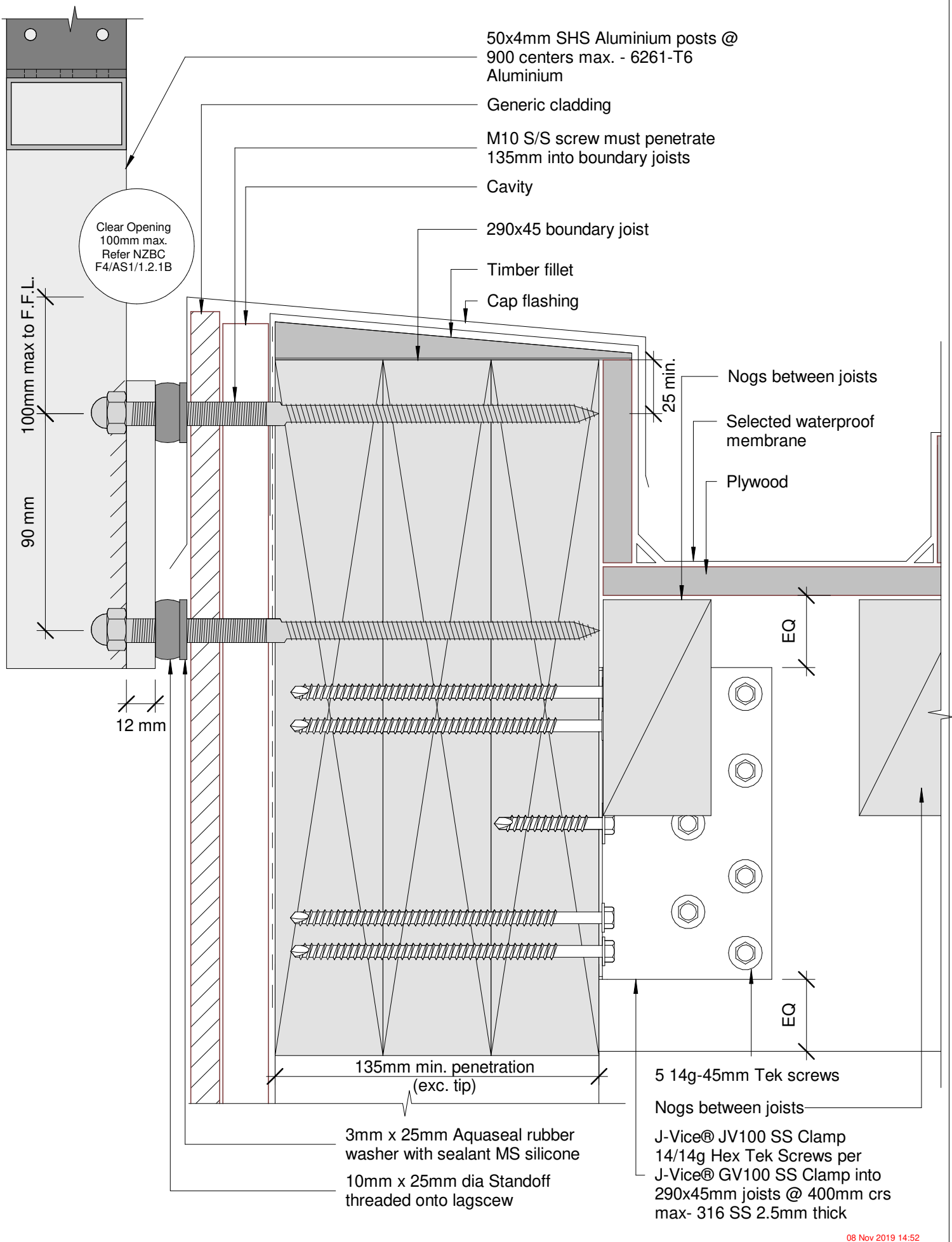

08 Nov 2019 14:52

© 2019. The copyright of this document is the property of Glass Vice Limited and shall not be reproduced, copied, loaned or disposed of directly, or indirectly, nor used for any purpose other than that for which it is specifically furnished without prior consent.

gv_vertbatt_Corey.rvt
All dimensions in millimetres



Vertical Battens

1200mm High Face Fixed into Timber

Detail - Face Fix Triple Joist 190 Standoff 1.2M Residential Barrier - 200 Top Rail **VB1212_FFP_110**

Date: October 2019

Scale: 1 : 2

Issue 01

www.glassvice.com

Phone +64 9 414 6565

info@glassvice.com